



Table of contents	2
Operating Elements	3
Important notes	4
Intended use	4
For your safety	4
Putting the fresh water kit into operation	5
Installation requirements	5
Installation	6
Installation Electric	7
Daily operation	8
Decalcify fresh water clip	8
LED indicators	9
Technical Data	9
Legal Information/Contacts	10

## Symbol description

### Symbols used

▶ Call to action. Here you are prompted to take an action.

**i** Hints and tips

# Operating elements

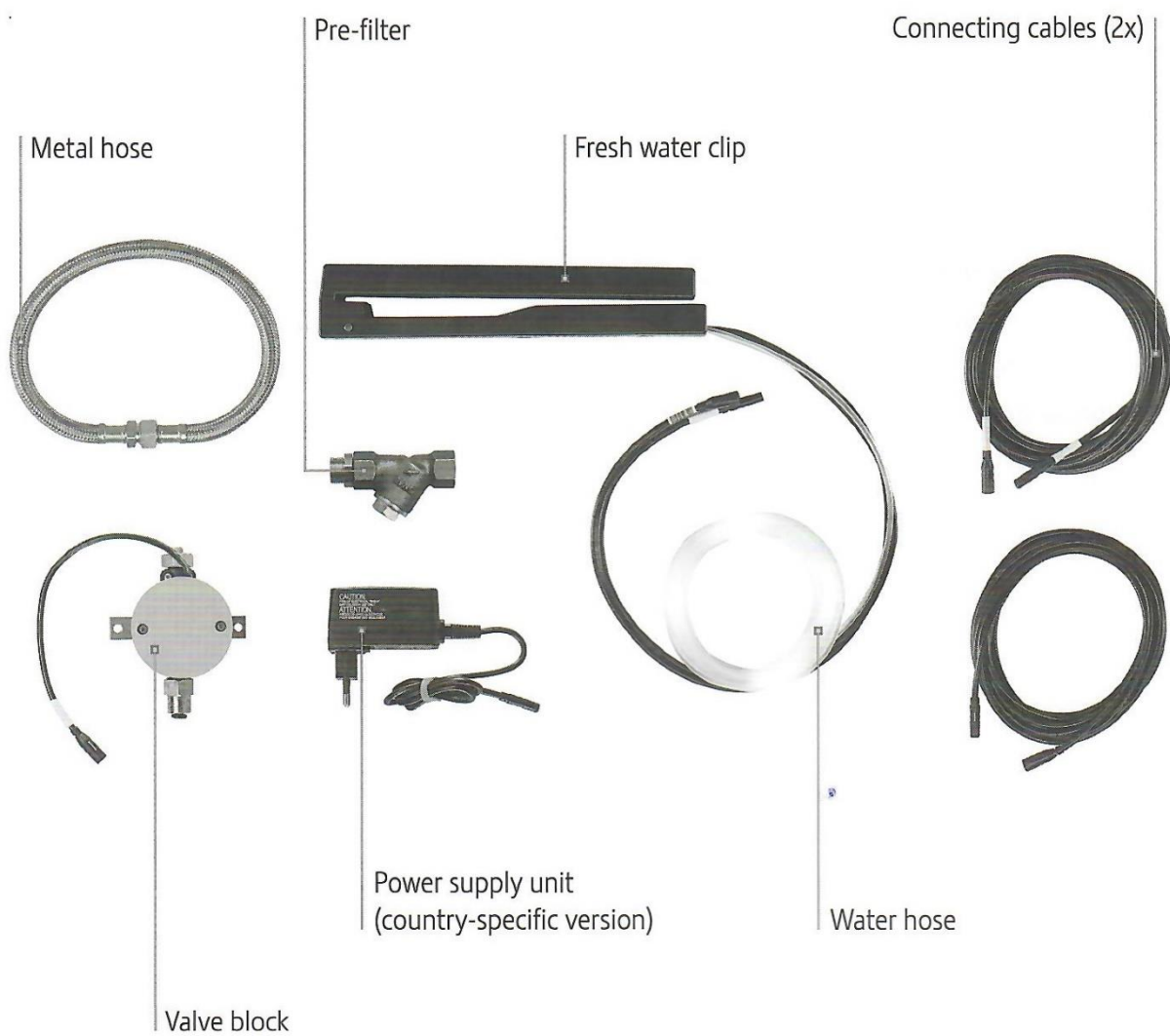

## Important notes

### Intended use

The fresh water kit is only intended to be used together with a Qeamer pasta machine. Any other use is considered improper. MyGusto accepts no liability for any consequences resulting from improper use. Read and observe these operating instructions in full before using the appliance.

The warranty does not cover damage or defects caused by failure to observe the operating instructions. Keep these operating instructions available with the unit and pass them on to subsequent users.

### For your safety

Ensure the correct installation of the fresh water kit to prevent unwanted water leakage.

- Only operate the unit with the mains adapter supplied.
- Always unplug the power supply unit from the power socket once you have closed the shut-off valve on the house side.
- Do not allow children to play with the machine.
- Children may not clean or service the machine without supervised by a responsible person.
- Children aged 8 and over may only operate the machine without supervision if they have been instructed on how to use it safely. Children must be able to recognise and understand potential dangers arising from incorrect use.
- Persons, including children, who;
  - do not have the physical, sensory or mental capabilities to use the machine safely
  - are inexperienced or lack knowledge

must be supervised by a responsible person when using it, or must be instructed in how to use it correctly.

# Putting the fresh water kit into operation

## Installation requirements

In order to be able to commission the fresh water kit properly, some preparations are necessary. The following preparations must be carried out properly:

- The mains connection for your Qeamer must be protected by a residual current circuit breaker (RCD).
  - It must be possible to interrupt the power supply to the Qeamer by means of a main switch.
  - Make sure that the house-side water pipe has been flushed before installation.
  - The house end of the permanent water connection (up to the supplied valve block) must have a shut-off valve with a non-return valve (type EA) and filter. Have a qualified person install the supplied pre-filter and the metal hose on the valve block.
  - The permanent water connection must be established in accordance with the technical data (see chapter 6 "Technical data")
- i** Have the necessary preparations carried out by a qualified person.
- i** The preparations must be completed before you can put the fresh water kit into operation.

We recommend fixing the valve block to the wall (see illustration).

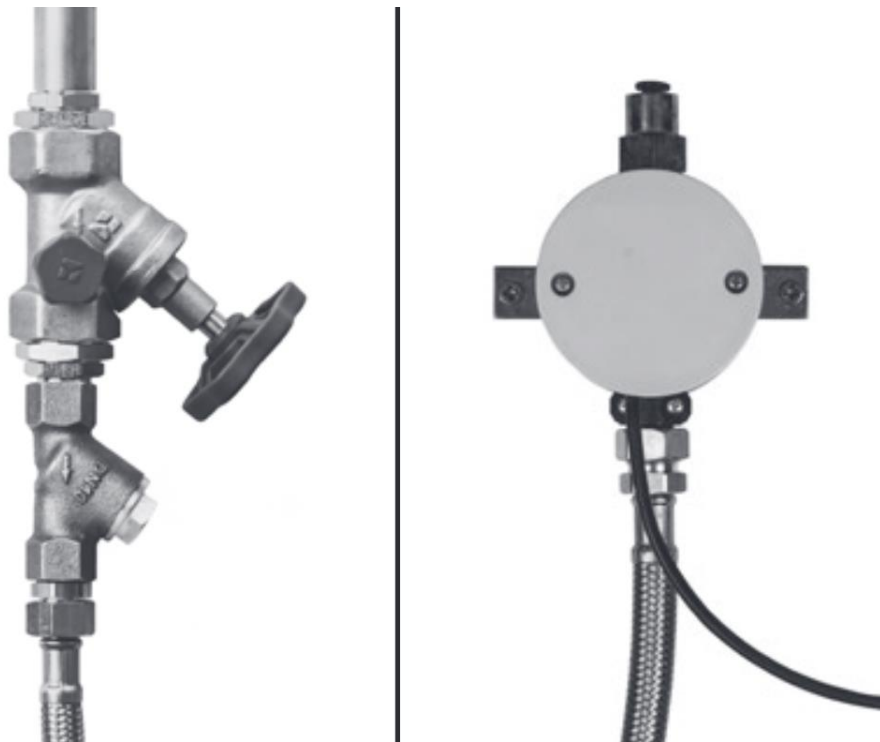

## Installation fresh water kit

**i** Rinse the fresh water clip under running water before using it for the first time

- ▶ Replace the original water tank with the machined water tank.
- ▶ Insert the fresh water clip into the empty water tank.
- ▶ Attach the supplied cable holder to the bottom right corner of the right-hand unit cover and fix the cables and leads as shown in the pictures.



- ▶ Insert the water hose firmly into the valve block.
- ▶ Check the water hose for tight fit and leakage.
- ▶ The water hose can be shortened according to your needs.

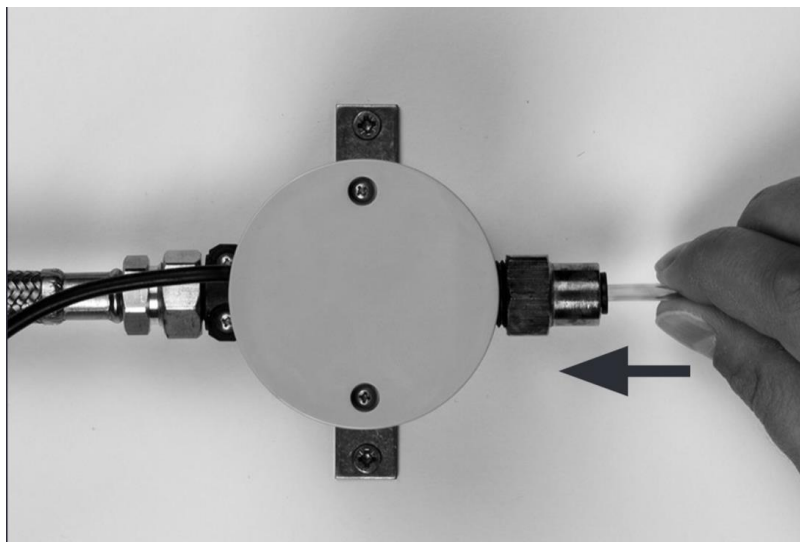

## Installation Elektrik

- ▶ Connect the yellow marked cable of the fresh water clip (1) with the yellow marked cable of the valve block (2).

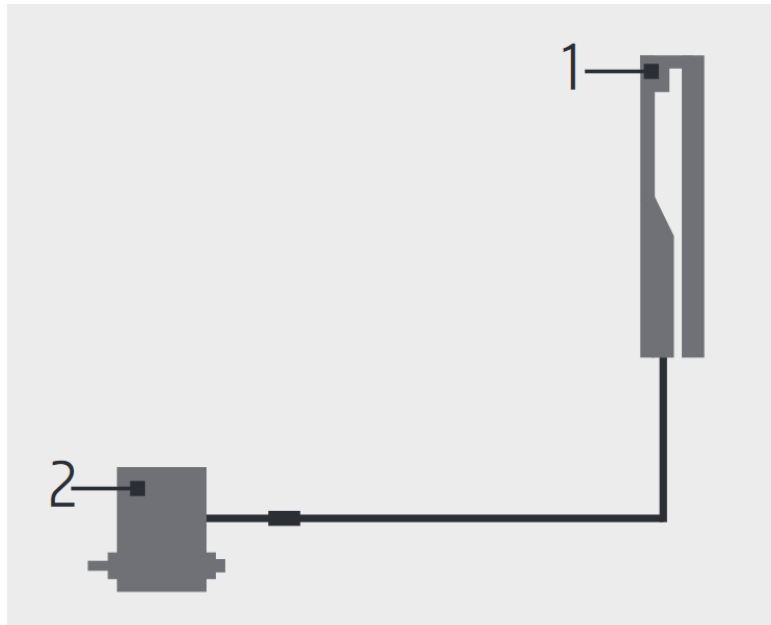

- ▶ Connect the second cable of the fresh water clip (1) to the cable of the power supply unit (3).

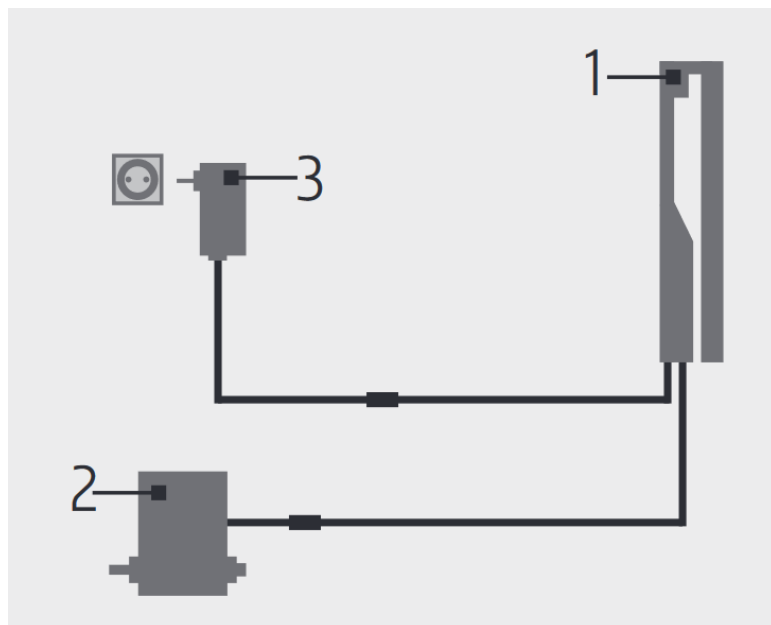

- i** If necessary, use one of the enclosed connection cables.
  - ▶ Plug the power supply unit into a mains socket.
- i** Empty the water tank after the first filling and rinse it well.

## Daily operation

Hygiene when handling water is crucial for a consistently perfect result.

Therefore, clean the fresh water clip and the water tank daily.

- ❗ Never insert the fresh water clip into the empty water tank when the stopcock is closed and the power pack is plugged into a mains socket. There is a risk of the valve block overheating.
- ▶ Close the shut-off valve.
- ▶ Remove the power supply unit from the mains socket.
- ▶ Remove fresh water clip and rinse thoroughly under running water.
- ▶ Remove water tank, empty and rinse.

## Decalcify fresh water clip

Limescale deposits can form on the fresh water clip. We recommend that you decalcify the fresh water clip regularly.

### ⚠ CAUTION

Irritations due to skin and eye contact with the decalcifying agent cannot be ruled out.

- ▶ Avoid contact with skin and eyes.
- ▶ Rinse off the descaling agent with clear water. After eye contact, consult a doctor.

### ⚠ CAUTION

Damage to sensitive surfaces (e.g. marble) through contact with the descaling agent cannot be ruled out.

- ▶ Remove splashes immediately.
- ▶ Close the shut-off valve.
- ▶ Remove the power supply unit from the mains socket.
- ▶ Prepare descaling solution in a tall container.
  - ▶ Immerse the fresh water clip in the decalcifying solution for approx. one hour<sup>1</sup> up to the indicated level.





- ▶ Rinse the receptacle thoroughly and fill with fresh water.
- ▶ Immerse and remove the clip approx. 10 times to rinse out the remains of the descaling solution.

**i** Limescale deposits may build up in the water tank. For this reason, you should remove and descale the water tank regularly.

## Checking the prefilter

Check the filter sieve in the pre-filter regularly (approx. every 3 month). To do this, unscrew the filter sieve and rinse it thoroughly under running water.

## LED indicators

Status LEDs at the top and side of the fresh water clip:

**O** light up red: Fresh water clip is not correctly attached in or the maximum switch-on time has been reached.

**O** do not light up: no error; fresh water clip works properly.

**O** flashing red: Error; the safety float has been activated. The water tank will not be filled any further. Perform descaling and empty the water tank. If the error persists, contact your customer service.

## Technical data

Voltage Input:	100-240 V ~, 50/60 Hz
Output:	12 V =
Ambient conditions:	Ambient temperature 10-35 °C
Conformity symbol:	CE
Length of connecting cable:	approx. 5 m
Water hose (∅ mm4):	approx. 5 m
Reinforced hose for water supply line with G 3/8" union nut:	approx. 0.5 m
Permitted valve operating pressure (in valve block):	1.5-10 bar
Filling capacity:	approx. 1000 ml/min

### Technical data for house end of permanent water connection:

Permanent water connection:	G 3/8" external thread
Water supply line:	Reinforced hose with G 3/8" union nut
Shut-off valve:	with non-return valve (type EA)

## Legal information

### Switzerland

My Gusto GmbH  
Arbonerstrasse 62a  
CH-8580 Amriswil

### Europa

My Gusto GmbH  
Im Schlatt 28/1  
AT-6973 Höchst  
Kundendienst Tel: +41 71 466 99 11

### Directives

The machine complies with the following directives:

- 2011/65/EU (RoHS)
- 1907/2006/EG (REACH)
- 2014/35/EU (Low Voltage Directives)
- 2014/30/EU (Electromagnetic Compatibility)
- 2009/125/EG (Ecodesign Directive)